

Legend:
D - Outer diameter
H - Height of the spotlight
D1 - Diameter of the cut

GL 223



Model	Watt	Lumen (lm)	Colour temp. (K)	Size (mm)			Catalogue number	Packing (pcs)
				D	H	D1		
GL223WH	21x1W	1470	4000-4300	180	95	160	92LED223WH	12
GL223WW	21x1W	1470	2700-3000	180	95	160	92LED223WW	12

Body: aluminium alloy | **LED type:** epistar

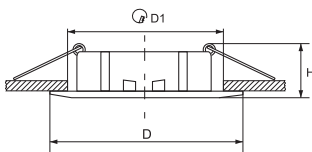

Legend:
D - Outer diameter
H - Height of the spotlight
D1 - Diameter of the cut

GL FILM



Model	Watt	Lumen (lm)	Colour temp. (K)	Size (mm)			Catalogue number	Packing (pcs)
				D	H	D1		
GL FILM215WH	5W	350	4000-4300	125	70	110	92LED215WH	20
GL FILM215WW	5W	350	2700-3000	125	70	110	92LED215WW	20

Body: aluminium alloy | **LED type:** epistar

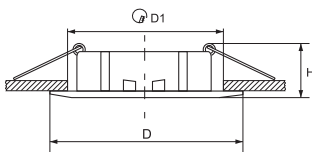

Legend:
D - Outer diameter
H - Height of the spotlight
D1 - Diameter of the cut

GL FILM



Model	Watt	Lumen (lm)	Colour temp. (K)	Size (mm)			Catalogue number	Packing (pcs)
				D	H	D1		
GL FILM216WH	10W	700	4000-4300	165	70	140	92LED216WH	20
GL FILM 216WW	10W	700	2700-3000	165	70	140	92LED216WW	20

Body: aluminium alloy | **LED type:** epistar

LED LIGHTING

Downlight fixtures

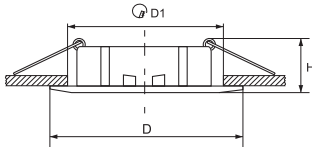

Legend:
D - Outer diameter
H - Height of the spotlight
D1 - Diameter of the cut

GL FILM



Model	Watt	Lumen (lm)	Colour temp. (K)	Size (mm)			Catalogue number	Packing (pcs)
				D	H	D1		
GL FILM 217WH	15W	1050	4000-4300	190	10	170	92LED217WH	10
GL FILM 217WW	15W	1050	2700-3000	190	10	170	92LED217WW	10

Body: aluminium alloy | **LED type:** epistar |

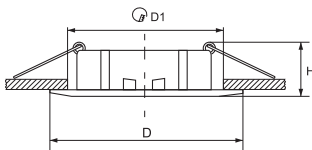

Legend:
D - Outer diameter
H - Height of the spotlight
D1 - Diameter of the cut

GL FILM



Model	Watt	Lumen (lm)	Colour temp. (K)	Size (mm)			Catalogue number	Packing (pcs)
				D	H	D1		
GL FILM 218WH	20W	1400	4000-4300	225	96	210	92LED218WH	10
GL FILM 218WW	20W	1400	2700-3000	225	96	210	92LED218WW	10

Body: aluminium alloy | **LED type:** epistar

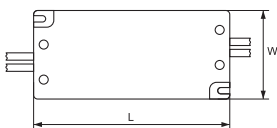

SETDC CONSTANT CURRENT DRIVER FOR DOWNLIGHTS



Model	Watt	Uinp/AC	Uout/DC	Iout	Size (mm)			Catalogue number	Packing (pcs)
					Length	Width	Height		
SETDCDW5	5W	230VAC	12~24VDC	320mA	45	43	25	99DRIVERDC5	50
SETDCDW10	10W	230VAC	26~43VDC	320mA	70	35	22	99DRIVERDC10	50
SETDCDW15	15W	230VAC	35~60VDC	320mA	100	40	22	99DRIVERDC15	50
SETDCDW20	20W	230VAC	18~35VDC	620mA	100	40	22	99DRIVERDC20	50