

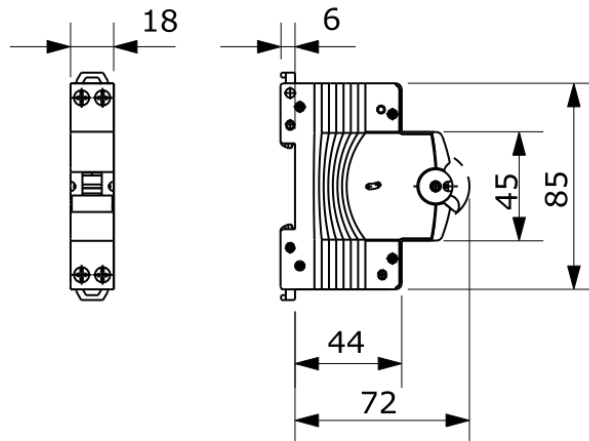

<b>Description</b>	COMPACT MINIATURE CIRCUIT BREAKER
<b>Code</b>	MTC 45
<b>No. of poles</b>	1P+N
<b>No. modules</b>	1
<b>Rated current</b>	6 A
<b>Curve</b>	C
<b>Rated voltage</b>	230 V

<b>Standard</b>	EN 60898, EN 60947-2	<b>Rated frequency (Hz)</b>	50/60 Hz
<b>Breaking capacity EN 60898 230V (Icn)</b>	4.500 A	<b>Breaking capacity EN 61009 (Ics)</b>	1 x Icn
<b>Breaking capacity EN 60947-2 230V (Icu)</b>	6 kA	<b>Breaking capacity EN 60947-2 (Ics)</b>	100% Icu
<b>Insulation voltage</b>	500 V	<b>Rated impulse withstand voltage</b>	4 kV
<b>Minimum operating voltage</b>	12V ac/dc	<b>Maximum operating voltage</b>	440V AC / 220V DC
<b>Electrical endurance</b>	10.000	<b>Mechanical endurance</b>	20.000
<b>Section rigid cable</b>	Max 16 mm <sup>2</sup>	<b>Section flexible cable</b>	Max 10 mm <sup>2</sup>
<b>Rated tightening torque</b>	1.2 Nm	<b>Operating temperature</b>	-25 +60 °C
<b>Stocking temperature</b>	-40 +70 °C	<b>Electrocod</b>	1411

### DIMENSIONAL



### STANDARDS/APPROVALS

