

**FAVOR DL**

Plafoniera hermetyczna / Hermetic wall & ceiling light fitting



FAVOR DL-60

- ▶ podstawa, klosz: poliwęglan (PC)
- ▶ base, lampshade: polycarbonate (PC)

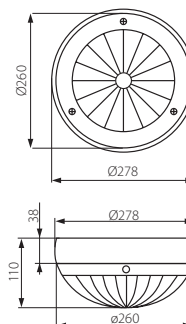

krzywa rozsyłu światłości /  
curve of intensity distribution  
 $\eta = 76\%$

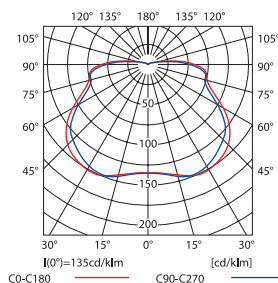

<b>Kanlux</b>		
FAVOR DL-60	07020	biały / white

220-240V~	50/60Hz	max 60		E27			2 x 1,5	0,5	IP 54	IK <sup>[J]</sup> 10			1/-/12	560	UV RESIST	CE
-----------	---------	--------	--	-----	--	--	---------	-----	-------	----------------------	--	--	--------	-----	-----------	----

wysoka odporność na uderzenia / high impact resistance

**MARC DL**

Plafoniera hermetyczna / Hermetic wall & ceiling light fitting



MARC DL-60

- ▶ podstawa, klosz: poliwęglan (PC)
- ▶ base, lampshade: polycarbonate (PC)

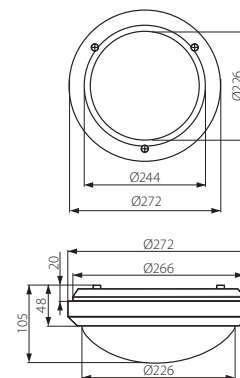

krzywa rozsyłu światłości /  
curve of intensity distribution  
 $\eta = 60\%$

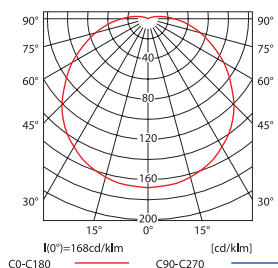

<b>Kanlux</b>		
MARC DL-60	07015	biały / white

220-240V~	50/60Hz	max 60		E27			2 x 1,5	0,5	IP 54	IK <sup>[J]</sup> 10			1/-/12	530	UV RESIST	CE
-----------	---------	--------	--	-----	--	--	---------	-----	-------	----------------------	--	--	--------	-----	-----------	----

wysoka odporność na uderzenia / high impact resistance